

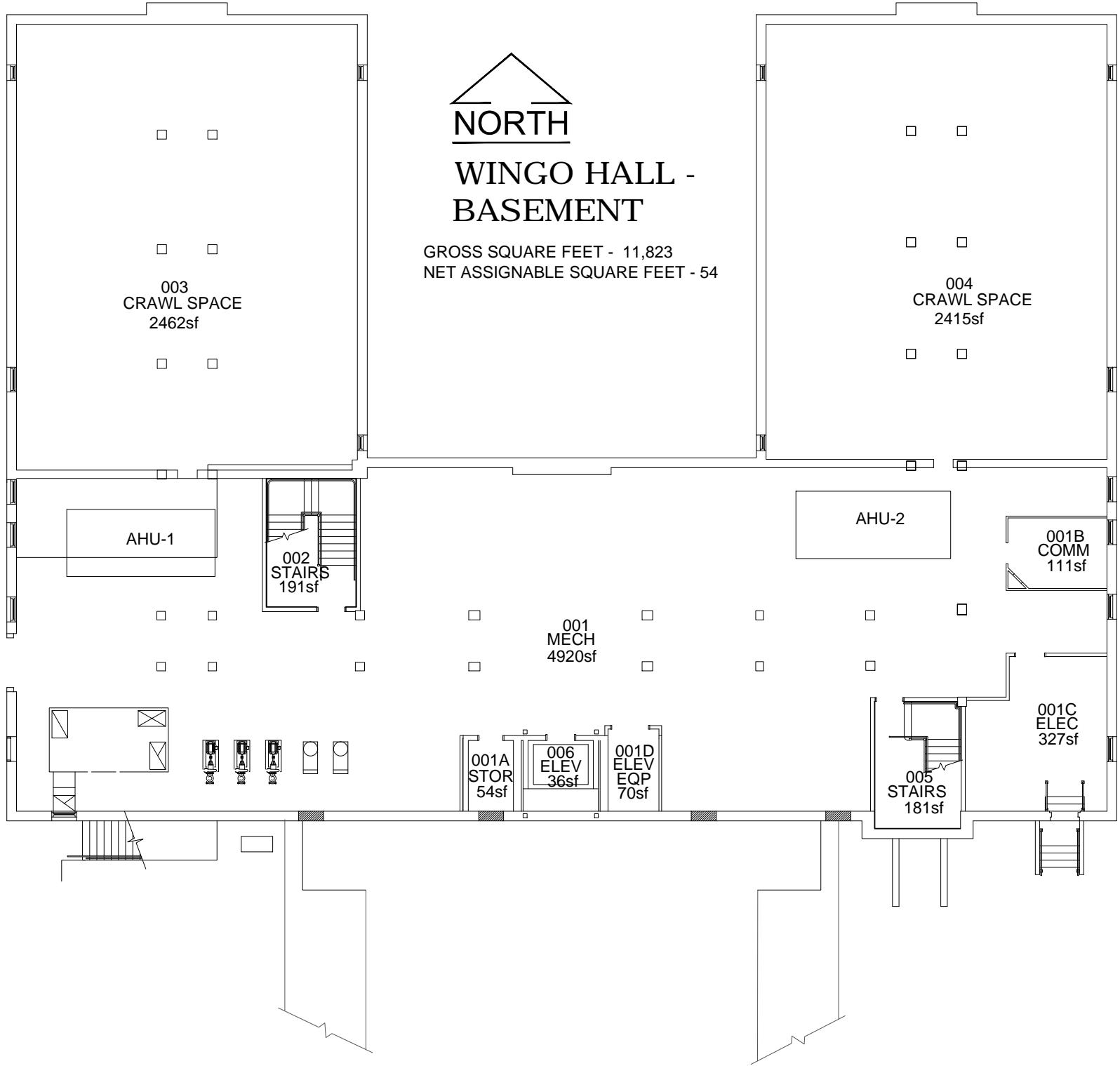

NORTH

WINGO HALL - BASEMENT

GROSS SQUARE FEET - 11,823
NET ASSIGNABLE SQUARE FEET - 54



003
CRAWL SPACE
2462sf

004
CRAWL SPACE
2415sf

AHU-1

AHU-2

002
STAIRS
191sf

001B
COMM
111sf

001
MECH
4920sf

001C
ELEC
327sf

001A
STOR
54sf

006
ELEV
36sf

001D
ELEV
EQP
70sf

005
STAIRS
181sf